

OG101

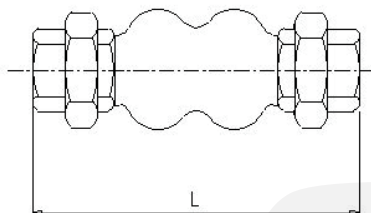
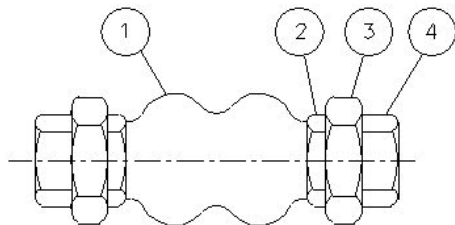

Dimensions [mm] DIN 2999

DN	INCH	L	Axiale Bewegung		Laterale Bewegung	Angolare Bewegung	bar	kg
			Komp.	Exp.				
20	3/4"	200	22	5	± 22	± 25°	10	0,71
25	1"	200	22	5	± 22	± 25°	10	1,09
32	1 1/4"	200	22	5	± 22	± 20°	10	1,31
40	1 1/2"	200	22	5	± 22	± 15°	10	1,78
50	2"	200	22	5	± 22	± 12°	10	2,65

Dimensions [mm] ANSI B2.1

DN	INCH	L	Axiale Bewegung		Laterale Bewegung	Angolare Bewegung	bar	kg
			Komp.	Exp.				
20	3/4"	200	22	5	± 22	± 25°	10	0,71
25	1"	200	22	5	± 22	± 25°	10	1,09
32	1 1/4"	200	22	5	± 22	± 20°	10	1,31
40	1 1/2"	200	22	5	± 22	± 15°	10	1,78
50	2"	200	22	5	± 22	± 12°	10	2,65

D OG101 nach DIN

- Muffenanschluss nach DIN 2999
- OG101 nach ANSI
- Muffenende nach ANSI B 2.1
- Balg: EPDM
- Max. Betriebsdruck: 10 bar
- Temperaturgrenzen (min./max.): -10°C ... +105°C

E OG101 acc. to DIN

- Threaded ends acc. to DIN 2999
- OG101 ecc. to ANSI
- Threaded ends acc. to ANSI B 2.1
- Bellows: EPDM
- Max. working pressure: 10 bar
- Working temp. (min./max.): -10°C ... +105°C



OG101

Materials

Nr.	Bauteil / Part	Material	Oberflächenbehandlung/Surface Treatment
1	Balg/Bellows	EPDM	
2	Schelle/Clamp	Carbonstahl/Carbon steel	verzinkt / Zinc plated
3	Verbindung/Union	Carbonstahl/Carbon steel	verzinkt / Zinc plated
4	Muffe/Racord	Carbonstahl/Carbon steel	verzinkt / Zinc plated

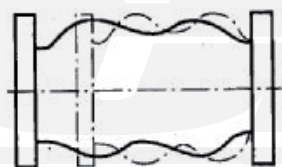

Axial compression



Axial stretch

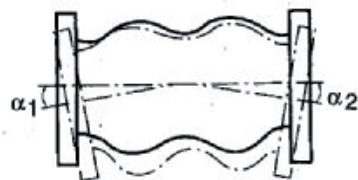

Angular deflection

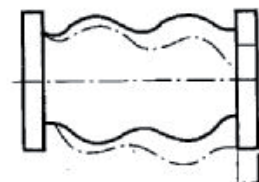

lateral displacement